



## Penguin Hybrid Floor Installation Guide

### **Installers Responsibility**

It is the installers responsibility to carry out the final inspection of the floor to ensure the colour.

The inspection needs to be carried out before it is installed by eying across each piece as you put the floor together to pick out any potential defects.

The installer must use reasonable selectivity and hold out pieces that should not be installed or cut off any deficiencies whatever the cause.

If the product is deemed not acceptable for any reason, do NOT install it and contact your supplier immediately. The product must be checked when accepting it from your retailer that the colour is correct as per customers invoice, also check with the end user that the right product has been supplied.

Once a product has been installed and any of the above warnings mentioned are not done correctly then no financial assistance can be given nor can the product be returned.

### **Note:**

Not every location is the same through out Australia, so please understand the environment you are installing the floor in, the perimeter expansion will need to be adjusted accordingly.

If the floor area across the width of the floor is excessive expansion joins need to be fitted to compartmentalise the large floor area into smaller ones so they will move independently of each other.

Different products will move at different rates due to their different structures and genetic properties, this also needs to be taken into consideration when allowing the right expansion , so if you are unsure about the product and how it will respond to the environment then please contact the manufacturer for guidance.

Flooring should never be stored outdoors.





**P E N G U I N**  
H Y B R I D

## Penguin Hybrid Floor Installation Guide

### **Expansion:**

Expansion required around the perimeter of the room and all fixed internal objects will vary on the type of product being installed, as a general rule we recommend at least 10-15mm expansion gap be allowed.

Please also be aware that over 12 l/m in the width of the floorboard, expansion joints should be installed to compartmentalise the total width into smaller moving areas.

Expansion joints come in many forms and colours please consult with the retailer if you require them.

### **Important:**

#### **Doorways:**

At doorways the door jam needs to be undercut well and all material removed for the timber floor to slide under and move freely, if required.

Doorways are also a very good place to insert expansion trims if required.

#### **Stairs:**

Flooring on stairs must be glued to the existing tread & riser, matching stair nosing to be fitted on the front edge of each step.

Also please make sure that the stair nosing meets the slip test guidelines for each state in Australia.

#### **Heat:**

In areas where the flooring comes into contact with a fire place, stove, heating system or direct sun light the floor will have a tendency to cause some shrinkage and gaps appearing. If possible protect the floor with blinds or a mat.



**P E N G U I N**  
H Y B R I D



## Penguin Hybrid Floor Installation Guide

### **Sub-Floor:**

The sub-floor should be dry and clean, absolutely flat and free of any cracks. Irregularities on the sub-floor should not exceed 3mm over 1 l/m in all directions uneven floors give you a bouncy feel when walked on and also possible squeaking will occur. In case there is a need to level the concrete sub-floor use a reputable cement based levelling compound.

### **Under Floor Heating:**

When installing over under floor heating system, ensure that the instruction of heating procedures is obeyed, before laying the floor.

The surface temperature from the underfloor heating must not exceed 27 degrees Celsius and the wattage should not exceed 60 watts/m<sup>2</sup>.

Turn on the heating system for at least 3 weeks prior to laying the floor and run at the desired temperature then switch off 48hrs before installation, the heating system can be started 1 week after the floor has been installed with gradual increases by 2 degrees increments each day until you reach the correct temperature and when turning off the heating system go down gradually by 2 degree increments each day until off.

### **Remember:**

Check your floor continuously during installation for defective boards or any situation that such as excessive noise when walking on the floor or even bounce vertical movement. seems not normal when installing Click flooring always use a tapping block to set the click properly so no squeaking occurs.





## Penguin Hybrid Floor Installation Guide

### *Installation Instructions:*

1



First plank, first row. Place a spacer of 15mm thickness to the left and position the plank against the wall. Later, after 3 rows, you can easily position the flooring against the front wall with distances  $\approx$  15mm.

2

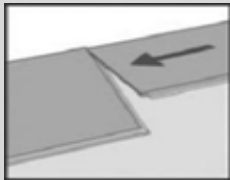

Second plank, first row place this plank gently and tight to the short end of the first one.

3



Fold the panel down in a single action movement. During the fold down, make sure the panels are tight against each other. Afterwards press down or slightly tap down at the short end just installed till it clicks.

No major force is required.

4

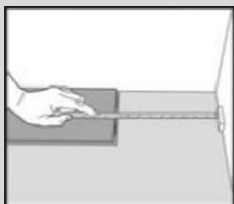

At the end of the first row, put a spacer  $\approx$ 15mm, to the wall and measure the length of the last plank to fit.





### *Installation Instructions:*

5

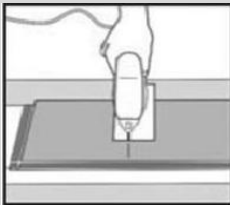

Cut with a jig saw - hardwood turned down to eliminate/reduce damage to the face of the panel. Or if cutting using a hand saw, cut it with the hardwood visible face up. Then install it as previous plank.

6

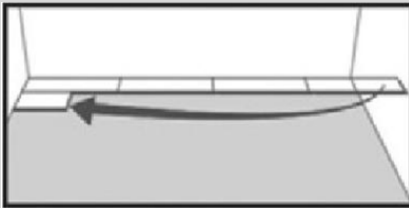

General distances between short ends. Minimum distance between short ends of planks in parallel rows shall not be less than 500mm. This is for stability of the floor.

7

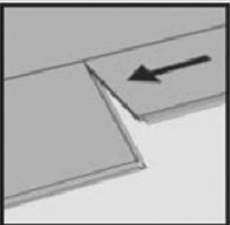

Second plank, second row place the panel at an angle into the groove of the previous row making sure that the end of the panel is tight/flush to the short end of the previous panel.

8

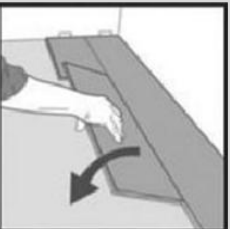

Fold the panel down in a single action movement with a slight press to the left to the short end of the previous panel. Again using the tapping block tap it against the long end into the previous row. During the fold down, make sure the panels are tight against each other.

9

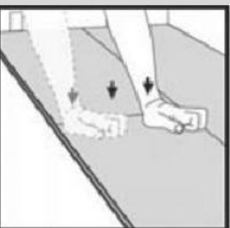

As it flattens itself to the floor, press or gently tap the top of the short end of the installed panel until it clicks. Finish installing this plank by tapping it with a tapping block on the long side to ensure secure installation.



PENGUIN  
H Y B R I D

## Penguin Hybrid Floor Installation Guide

### *Installation Instructions:*

10

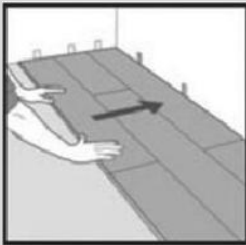

After 2-3 rows, adjust the distance to the front wall by placing spacers  $\approx 15\text{mm}$ . Once the adjustment is done against the main wall, continue to install till the last row.

11

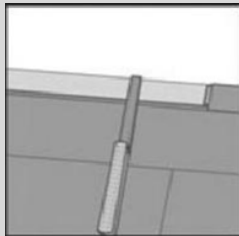

Last row (and perhaps also first row).  
The minimum width of the last plank should be NOT LESS than 50mm.  
Remember distance to wall is 15mm. TIP: Put a spacer before measuring.  
Cut the panels lengthwise and glue the short ends. See instructions below.

PENGUIN  
H Y B R I D

## Special Instructions:

### Special Installations - Small Panel Widths

Joining at short ends length cut panels. Cut the tongue at the same time you cut the length of the panel and install as shown above. Please note that the smallest width of a panel is 50mm at the last row. If it is not, the first row width must be adjusted.

This can easily be calculated when measuring the room with before installation. Cut off the locking element with a chisel, push the planks horizontally together.

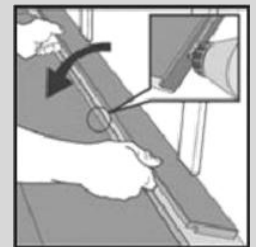

### Radiator Pipes



Installation at radiators. Drill the holes 20mm larger than the diameter of the pipes. Cut out the panel (with the thinnest blade possible) as per diagram. Install the plank as per normal. Glue the cut out piece back again.

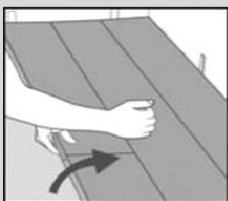

### Disassembling

Your floor can very easily be disassembled, which enables replacement during installation and also during use.

- Separate the whole row by carefully lifting up and slightly knocking just above the joint. Fold up and release the whole long side.
- Disassemble the panels by sliding horizontally. (Do not fold up)

